

Gegenring Type A

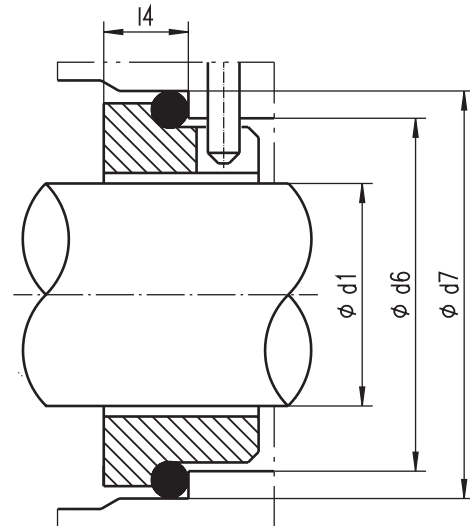

Werkstoffe

Gegenring: SIC (U32)
 Kohle (Z32)
 Hartmetall (K22)
 Chromguss (Y1)
 Keramik (C)
 Edelstahl (E)

Elastomer: Viton (V)
 EPDM (D)
 PTFE (T)

| d ₁ | d ₆ | d ₇ | l ₄ |
|----------------|----------------|----------------|----------------|
| 10 | 17 | 21 | 10,0 |
| 12 | 19 | 23 | 10,0 |
| 14 | 21 | 25 | 10,0 |
| 15 | 21 | 25 | 10,0 |
| 16 | 23 | 27 | 10,0 |
| 18 | 27 | 33 | 10,0 |
| 20 | 29 | 35 | 10,0 |
| 22 | 31 | 37 | 10,0 |
| 24 | 33 | 39 | 10,0 |
| 25 | 34 | 40 | 10,0 |
| 28 | 37 | 43 | 10,0 |
| 30 | 39 | 45 | 10,0 |
| 32 | 42 | 48 | 10,0 |
| 33 | 42 | 48 | 10,0 |
| 35 | 44 | 50 | 10,0 |
| 38 | 49 | 56 | 11,0 |
| 40 | 51 | 58 | 11,0 |
| 43 | 54 | 61 | 11,0 |
| 45 | 56 | 63 | 11,0 |
| 48 | 59 | 66 | 11,0 |
| 50 | 62 | 70 | 11,0 |
| 53 | 65 | 73 | 13,0 |
| 55 | 67 | 75 | 13,0 |
| 58 | 70 | 78 | 13,0 |
| 60 | 72 | 80 | 13,0 |
| 65 | 77 | 85 | 13,0 |
| 68 | 81 | 90 | 15,0 |
| 70 | 83 | 92 | 15,0 |
| 75 | 88 | 97 | 15,0 |
| 80 | 95 | 105 | 15,5 |
| 85 | 100 | 110 | 15,5 |
| 90 | 105 | 115 | 15,5 |
| 95 | 110 | 120 | 15,5 |
| 100 | 115 | 125 | 15,5 |

Stand 06/07

Änderungen jederzeit vorbehalten



Robert-Bosch-Str. 12
 49134 Wallenhorst

Tel.: 05407/81740
 Fax: 05407/817420

fluiten@fluiten.de
 www.fluiten.de